



**GRAH BUILDERS &
DEVELOPERS PVT LTD**
HOME FOR LUXURY



Artistic Impression

**UPTO
90%
FINANCE
AVAILABLE**



GRAH VILLAS
LAULAI, GOMTI NAGAR EXT.

*Your Dream Home
Awaits You !*

WELCOME TO GRAH BUILDERS AND DEVELOPERS PT. LTD.

Grah Builders and Developers Pvt. Ltd. was established with the progressive thought and focused vision. Since its inception, Grah Builders and Developers Pvt. Ltd. has delivered exclusive developments with a unique combination of traditional and contemporary designs. With the passion for creating vibrant and sustainable communities. aims to build not just homes. but a valuable legacies. It aims to build dream homes that are pocket-friendly and create spaces where life meets lifestyle. Grah Builders and Developers Pvt. Ltd. has continually pioneered newer technologies, bold design and precision engineering to create landmark residential townships. Propelled by the drive to change expectations and the lifestyle of people thus changing. the trend of skyline in the city; Grah Builders and Developers Pot. Ltd. has ushered in an era marked by higher standards of living and global lifestyles. Grah Builders and Developers Pvt. Ltd, is growing today as leading real estate group with its flagship business of construction in Lucknow:

DELIVERED PROJECTS

Grah Enclave Phase - 1

Near Awadh Shilp Gram

40 + Houses Delivered

Grah Enclave Phase - 3

Tiwariganj Faizabad Road

50 + Houses Delivered

Grah Enclave Phase - 5

Near STP Chauraha

20 + Houses Delivered

Grah Enclave Phase - 7

Sarswan Sultanpur Road

20 + Houses Delivered

DELIVERED PROJECTS

Grah Enclave Phase - 2

Bijnaur Road

30 + Houses Delivered

Grah Enclave Phase - 4

Near Chinhat Tiraha

50 + Houses Delivered

Grah Enclave Phase - 6

Tiwariganj Faizabad Road

80 + Houses Delivered

Grah Paradise

Safedabad

40 + Houses Under Construction



**GRAH BUILDERS &
DEVELOPERS PVT LTD**
HOME FOR LUXURY

SOCIETY VIEW



Artistic Impression



GRAH BUILDERS & DEVELOPERS PVT LTD
HOME FOR LUXURY



GRAH VILLAS
LAULAI, GOMTI NAGAR EXT.

SITE PLAN

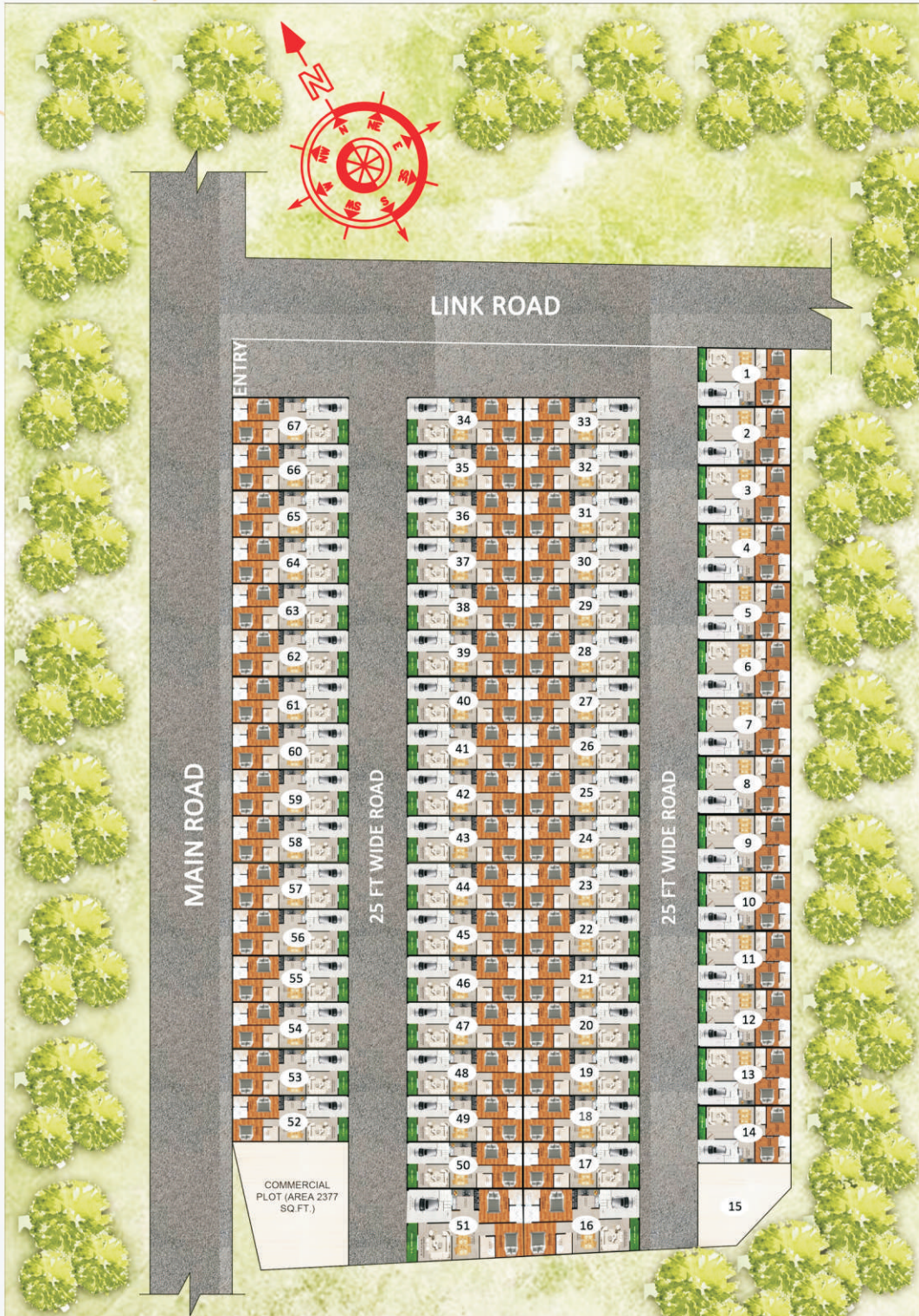

**SITE PLAN: GRAH VILLAS
LAULAI, GOMTI NAGAR, LUCKNOW**



GRAH BUILDERS & DEVELOPERS PVT LTD
HOME FOR LUXURY

FLOOR PLAN



GROUND FLOOR

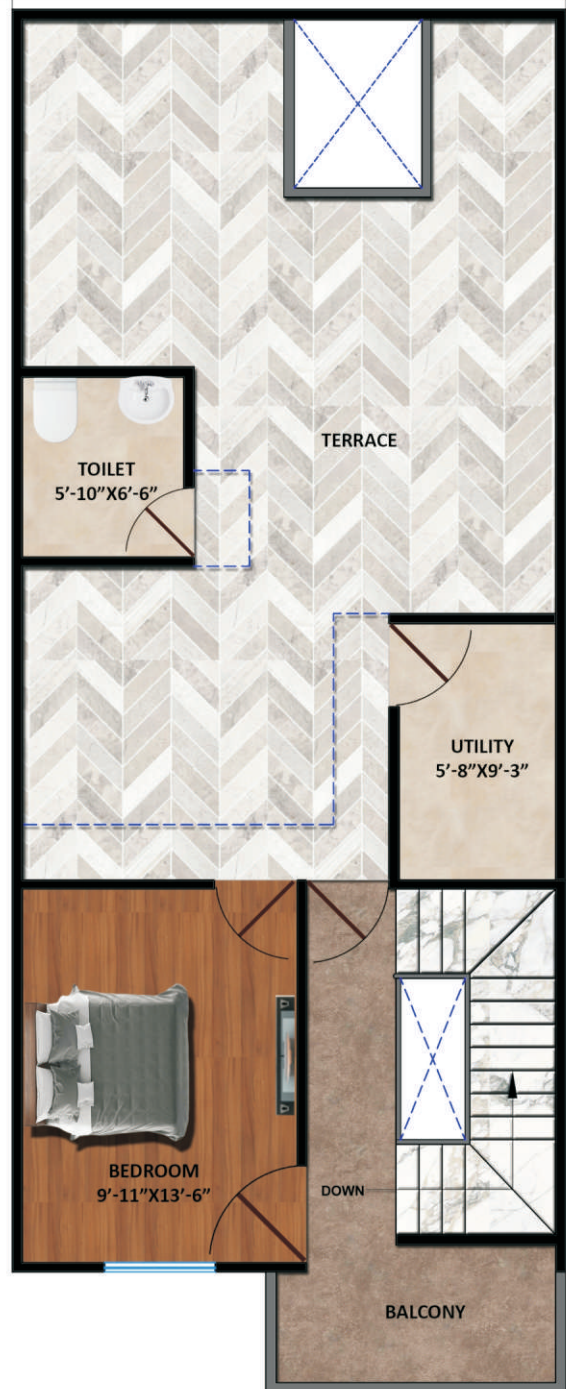

FIRST FLOOR

- **Painting**
 - Oil bound distemper/for internal painting work.
 - External apex (Asian/Berger)
 - Wall putty will be JK or Birla brand
 - False ceiling in Drawing, dinning and bedrooms.
- **Electrical Work**
 - Electrical wiring will be havells/anchor/RR brand or its equal brand.
 - All switches will be havells/anchor/RR/Great white modular normal brand or its equal brand.
- **Mild Steel Work**
 - Front gate will be of SS.
 - Window will be of Upvc
 - Front railing will be of toughen glass.
- **Wooden Work**
 - Semi modular kitchen with Chimney of Elica or its equal brand
 - All doors will be ready-made flush doors 32mm thickness any ISI brand.
 - All toilet doors will be PVC.
- **Flooring Work (Vitrified tiles)**
 - All floor tile will be 600x600 ISI vitrified tile
 - All toilet wall tile will be 300x450 and floor will be 300x300.
 - Porch tile will heavy duty industrial tiles 300x300.
 - Kitchen top 2 feet height tile will be 300x450 and floor will be 600x600.
 - Stair case steps will be Granite
- **Stainless Steel**
 - Stair case railing will be of SS Steel of 202 grade.
- **Bathroom and Kitchen Fixers**
 - All CP fittings will be Cera normal brand or its equal brand.
 - All toilet fixers will be Cera normal brand or its equal brand.
 - Sink in kitchen will be size of 450x600.

AMENITIES



**GATED SECURED
COLONY**



**24 HOURS
SECURITY**



**24 HOURS
TRANSPORTATION**



**MAIN ROAD 25 FEET
& LINK ROAD 30 FEET**



**SCHOOLS
NEARBY**



**COMMERCIAL
SPACES**

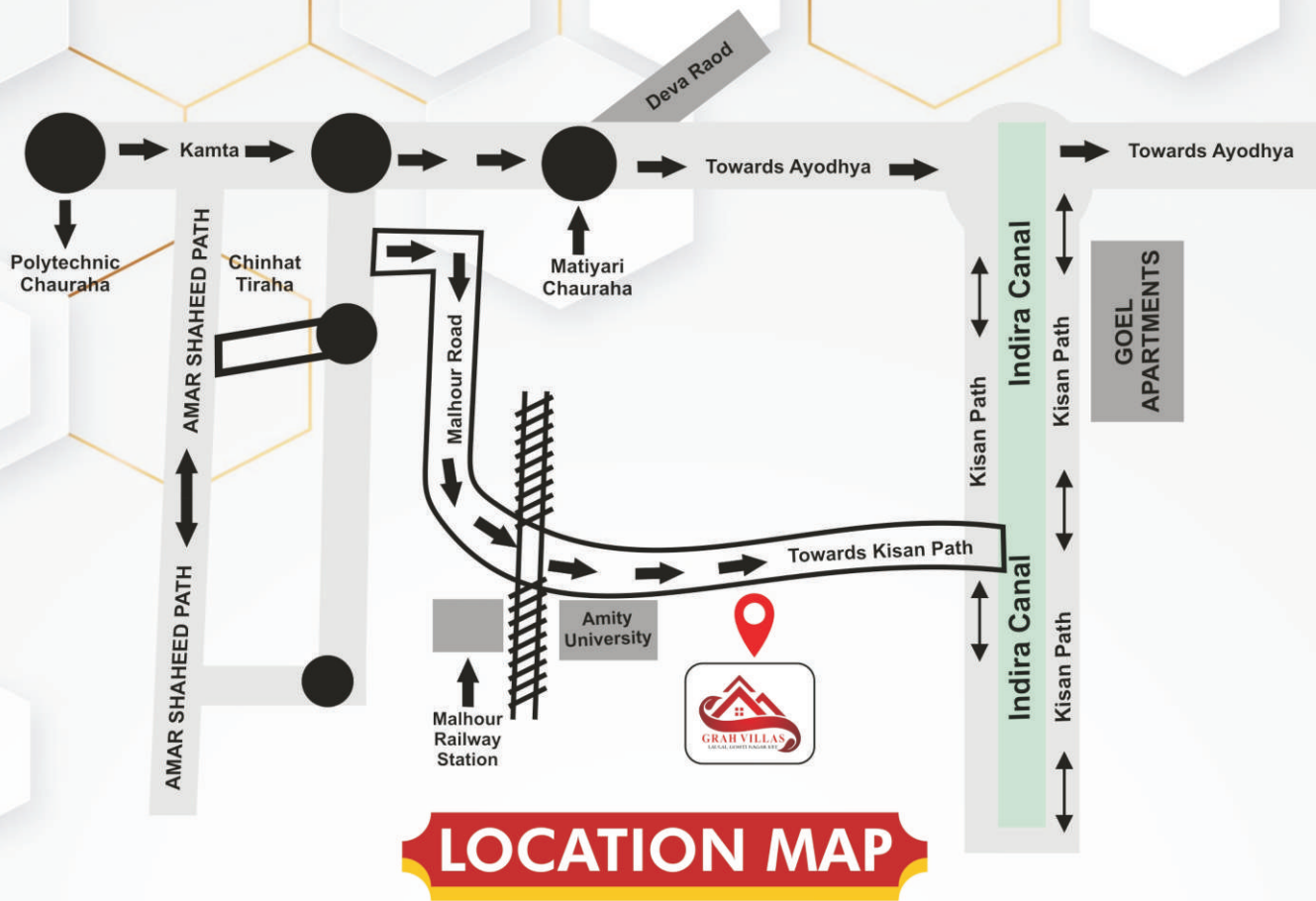

**GRAH BUILDERS &
DEVELOPERS PVT LTD**
HOME FOR LUXURY

📍 **OFFICE ADDRESS: PLOT NO 1391 ELDECO UDHYAN 2
SHARADA NAGAR YOJNA, AMAR SHAHEED PATH, LUKCNOW**
www.grahbuilders.com | info@grahbuilders.com